

Square D® Clipsal® Neo™ Keypads



Frontal view of Neo keypad

Square D® Clipsal® Neo™ Keypads offer localized finger-tip control of lighting and other electrical devices. With over 1,000 custom color combinations available, these elegant keypads are suitable for virtually any decor.

One compact Neo keypad can take the place of many single switches, ON/OFF toggles, dimmers, and timers. Available in your choice of a two-, four-, or eight-button keypad, Neo's modern style is complemented by orange and blue LEDs that instantly show the status of controlled devices.

Multi-Functional Capabilities

- Button configurations include multi-point switching and dimming, master ON/OFF switching, and scene settings
- Scene control includes ten group addresses per scene, four scenes per keypad
- Independent timers available for each button
- Standard built-in infrared receiver permits keypad control at a distance with an optional infrared handheld remote
- Dual-color LED windows on each button can glow in cool blue, orange, or combinations of both, indicating when a controlled device is ON or OFF
- Auto "fallback" can dim button LEDs at a set time after the last key press
- Locator LEDs can illuminate the top and bottom of the button area in cool blue, helping a user find the keypad in dim light

Functional Aesthetics

- Clean-lined low-profile keypads are wall mounted without external fittings
- Optional button covers have ID windows, enabling quick identification of lighting scenes or controlled devices
- Distinctively designed multi-layer cover plate consists of button covers, an outer surround, and an inner surround
- Color schemes are easily customized and modified to suit personal taste or the décor

Distributed Intelligence

- Compatible with all Clipsal devices and the Square D® Powerlink® NF3000G3C controller
- Configured by using Learn Mode or a personal computer connected to the network

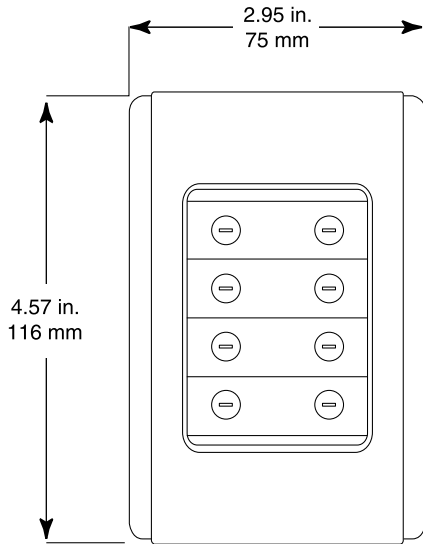

Frontal view of keypad, including external length and width measurements of case

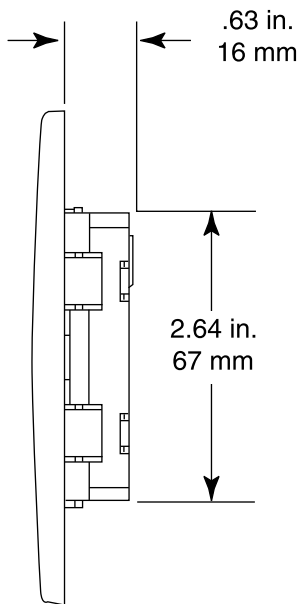

Side view of keypad, including height and depth requirements for insertion into wall

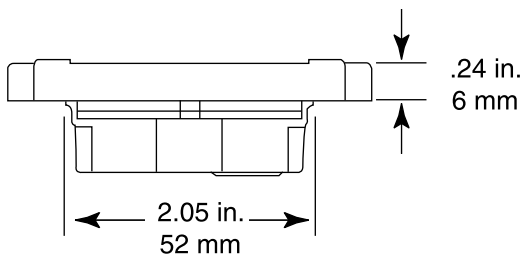

Bottom view of keypad, including measurements for width of unit and depth case extends from wall

Specifications

Neo Keypad	
Voltage Requirements	15–36 V DC @ 22 mA required for normal operation, drawn from the C-Bus network
Number of Units on a Network	Calculated with the C-Bus Calculator, a software utility used to evaluate the total network current load
Electrical Isolation	3.75 kV RMS from C-Bus to power (provided externally)
Control Functions	Load switching, dimming, timing, scene control
Status Indicators	Two-color (orange and blue) user-configurable LEDs
Locator Option	User-configurable, adjustable blue LED illumination for locating the unit in darkness, with “ignore first button press” option
Scene Control	Up to four scenes per keypad, ten addresses per scene
Timers	1 sec–18 hr, 1 sec intervals
Response Time	200 msec or less
C-Bus Connection	One terminal block to accommodate 24–16 AWG (0.2–15 mm ²), CAT 5 UTP cable required
Dimensions	4.57 in. (L) x 2.95 in. (W) x 0.87 in. (D) [116 mm (L) x 75 mm (W) x 22 mm (D)]
Mounting	
Centers	3.31 in. (84 mm)
Enclosure (Not Provided)	<ul style="list-style-type: none"> Plaster mud ring (Raco 8771 or equal) w/minimum internal width 2.05 in. (52 mm) (not provided) Single gang box (Carlon A58381D-CAR or equal) w/minimum internal width 2.05 in. (52 mm) (not provided)
Weight	2.7 oz (77 g)
Operating Environment	<ul style="list-style-type: none"> Temp.: 32°F to 113°F (0°C to 45°C) RH: 95%, noncondensing
Storage Environment	<ul style="list-style-type: none"> Temp.: 14°F to 140°F (–10°C to 60°C) RH: 95%, noncondensing
Standards	<ul style="list-style-type: none"> UL: Listed 916 Energy Management CSA 22.2 Spec 205 Signal Equipment FCC: Part 15.101, Class B Digital Device EN61000-4-2 Immunity to ESD
Color Options	Slate, white, cream, gold, black, brown, soft gray, desert sand and brushed aluminum

Neo Keypad — Specifying Colors When Ordering

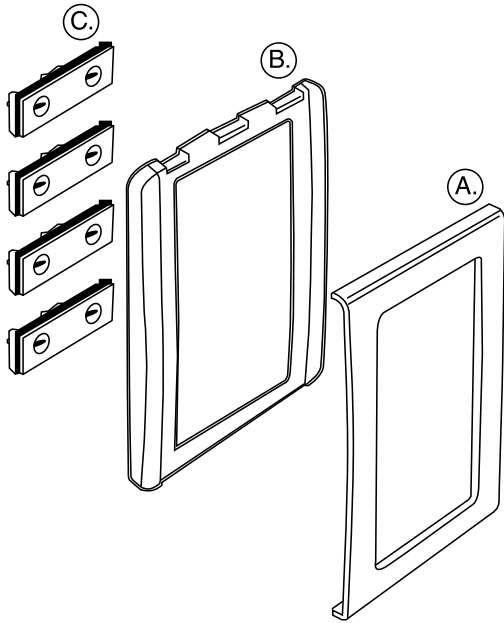

Components of the Neo Keypad cover plate:
 A. Inner Surround, B. Outer Surround,
 C. Button Covers

Keypad Assemblies

Order numbers for the Neo Keypad assemblies indicate the number of buttons desired on the keypad and the color of each customizable component (inner surround, outer surround, and button cover).

Color numbers are taken from the “Neo Colors” table and must be given in the following order: outer surround, inner surround, and button covers.

For example, in the diagram below, SLC5058NL282 represents an order for a Neo Keypad with eight buttons, a white (#2) outer surround, a brushed aluminum (#8) inner surround, and white (#2) button covers.

Keypad Assemblies Standard

For easy ordering there are 3 standard keypad colors available.

- White: SLC505()NLWE
 - Cream: SLC505()NLCM
 - Brushed Aluminum w/Slate: SLC505()NLGB
- () - designates space for button configuration

SLC505(8)NL(2)(8)(2)

Catalog Number	Keypad Buttons
2	Two
4	Four
8	Eight

Outer Surround Color
 Inner Surround Color
 Button Cover Color



SLC505()NLWE



SLC505()NLCM



SLC505()NLGB

Name	Color Number	Color
Slate	1	
White	2	
Cream	3	
Soft Gray	4	
Desert Sand	5	
Black	6	
Brown	7	
Brushed Aluminum*	8	
Gold*	9	

*Only the inner surround is available in Brushed Aluminum and Gold

Order Information

Note: When specifying colors for complete Neo Keypad assemblies, verify that you have listed the colors in the following sequence: Outer Surround, Inner Surround, and Button Cover.

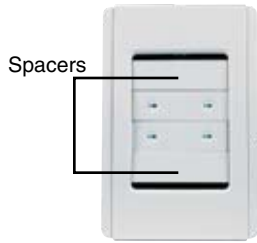

Four-button Neo Keypad with spacers



Neo button cover with ID window



Optional hand-held infrared remote control (catalog # SLC5038TX)

DESCRIPTION	CATALOG NUMBER		
	Number of Buttons		
	Two	Four	Eight
Neo Keypad Assembly (2, 4, or 8 buttons)	SLC5052NL()	SLC5054NL()	SLC5058NL()

Accessories

Certain accessories have unique catalog numbers. To specify colors for them, just add the color number to the end of the catalog number. For example, SLC5052NRI5 is the catalog number for a desert sand button cover with an ID window. To order a pack of these button covers in desert sand, specify SLC5052NRI5.

ACCESSORIES	
Button Covers	SLC5052NRP() - 2 button keypads (5 pack) SLC5054NRP() - 4 button keypads (5 pack) SLC5058NRP() - 8 button keypads (5 pack)
Button Covers with ID Windows (pack of 10)	SLC5052NRI()
Inner Surround (pack of 5)	SLC5050IS()
Outer Surround (pack of 5)	SLC5050OS()
Optional Infrared Remote Control	SLC5038TX

Schneider Electric North American Operating Division

295 Tech Park Drive
LaVergne, TN 37086
Tel: 1-888-squared
www.squaredlightingcontrol.com

Square D, the  logo, Powerlink, C-Bus, Clipsal, Saturn and Neo are trademarks or registered trademarks of Schneider Electric and/or its affiliates in the United States and/or other countries.