

50/60 HZ AC3 DUTY

CATALOG	SINGLE PHASE		THREE PHASE			
	115V	230V	200V	230V	460V	575V
D25	2 HP	3 HP	7.5 HP	7.5 HP	15 HP	20 HP
D32	2 HP	5 HP	10 HP	10 HP	20 HP	30 HP

COIL VOLTAGES FOR LC1 D09 TO D80

VOLTS	50/60 HZ CODE (1)	STD. DC (1)	LOW CONSUMPTION DC (1) *
12	-	JD	-
24	B7	BD	BL
48	E7	ED	EL
72	-	SD	SL
110	F7	FD	-
125	-	GD	-
115	FE7	-	-
120	G7	-	-
220	M7	MD	-
230	P7	-	-
240	U7	-	-
250	-	UD	-
380	Q7	-	-
400	V7	-	-
415	N7	-	-
440	R7	RD	-

* AVAILABLE IN UP TO 32A MAX

CONTACTOR WITH AC COIL

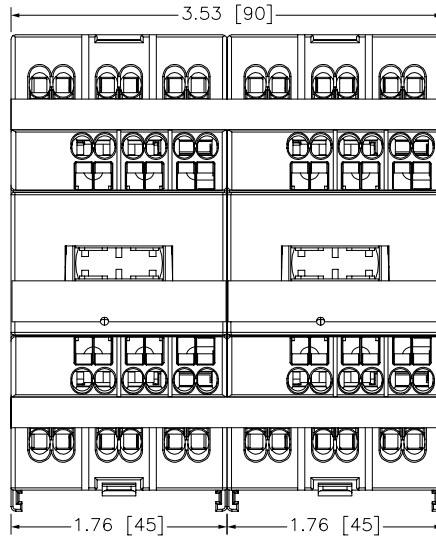

CONTACTOR WITH DC COIL

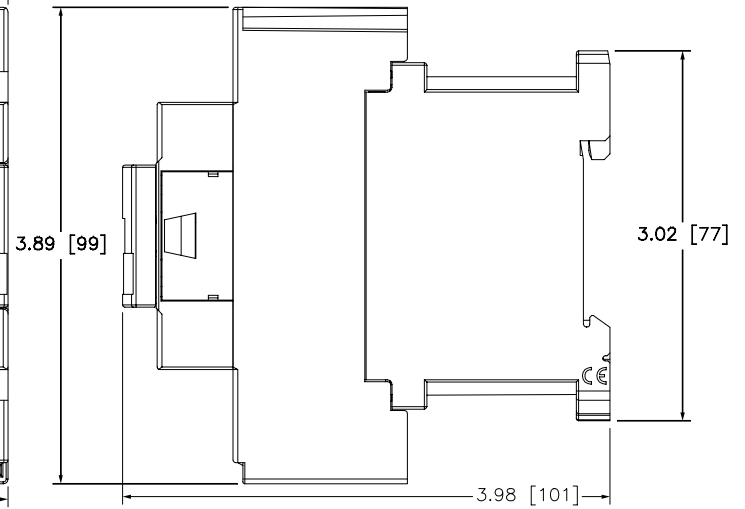
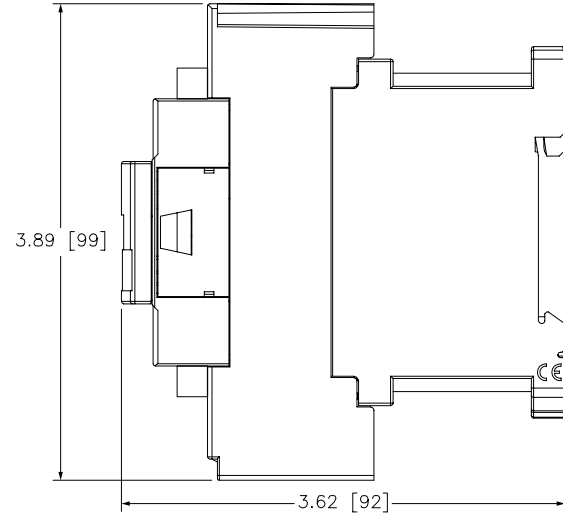
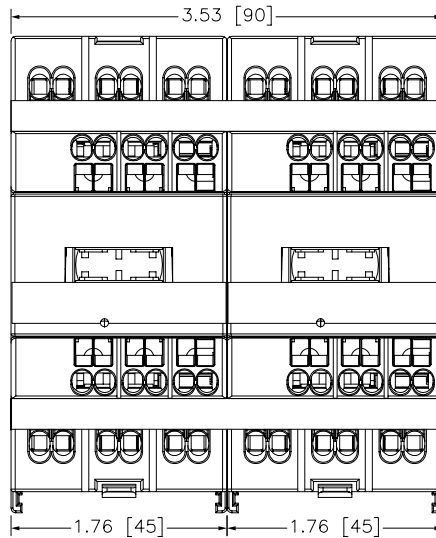

Catalog Number: LC2D253(1), LC2D323(1)
 Ratings: 600V/25A
 UL File/CCN: E48539/NLDX
 CSA File/Class: LR43364/3211 04
 Meets Standards: IEC 60947-4
 Weight: 1.1kg
 Wire Size: #14
 Termination Method: Spring Terminals
 Terminal torque: N/A
 Mounting Hwd.: 35mm DIN rail, #8 screws

"THE SQUARE D COMPANY HAS PROPRIETARY RIGHTS TO THE INFORMATION CONTAINED HEREON. THIS INFORMATION REMAINS THE PROPERTY OF SQUARE D COMPANY AND MAY BE USED ONLY IN CONFORMANCE WITH INSTRUCTIONS ISSUED BY SQUARE D COMPANY. USER SHOULD VERIFY DRAWINGS ARE TO THE LATEST/CURRENT REVISION PRIOR TO INCORPORATING IN A DESIGN FILE."

DO NOT SCALE DRAWING
 UNLESS OTHERWISE SPECIFIED DIMENSIONS ARE IN INCHES

THIRD ANGLE PROJECTION
 TOLERANCES
 UNLESS OTHERWISE SPECIFIED
 2 PLACE DECIMALS ± .01

IEC CONTACTOR
 LC2D253(1), LC2D323(1)

SQUARE D COMPANY

DWG# LC2D25_32_3_OD
 NO.